



Mechanical Technology

The *TUC, tracked utility carrier*, features comfort seating, a powerful engine and a patented quick-attach system. *TUC* - a new standard for safety, performance, ride quality and implement attachments for all-terrain vehicles.

Comfort

- Integrated track suspension absorbs rough terrain while maintaining vehicle stability
- Air ride seat with fully adjustable features and lumbar support to ensure all-day comfort
- Engine is isolated from the chassis to reduce vibrations and noise during operation
- Sound and thermal insulation used to improve the operating experience

Safety

- ROPs – Roll Over Protection system ensures operator protection
- Parking Brake engages automatically
- Integrated hydraulic safety features
- Protective panels reduce pinch hazards and prevent debris from being thrown

Performance

- 37 HP Briggs & Stratton Engine provides plenty of power to get work done
- Load sensing hydraulics provide efficient “on-demand” power to the tracks
- Hydraulics are designed for maximum efficiency with minimum noise
- Integrated Quick Attach features for attachments and implements
- Robust frame and track design for maximum off-road performance

Service

- Easy access to all service points: mechanical, hydraulic and electrical
- Simple routine maintenance
- Track bushings are designed for harsh conditions and long service intervals
- Backed by 1 year bumper-to-bumper warranty



The TUC conveniently combines a tractor and a tool carrier through its patented attachment method.

LOADER

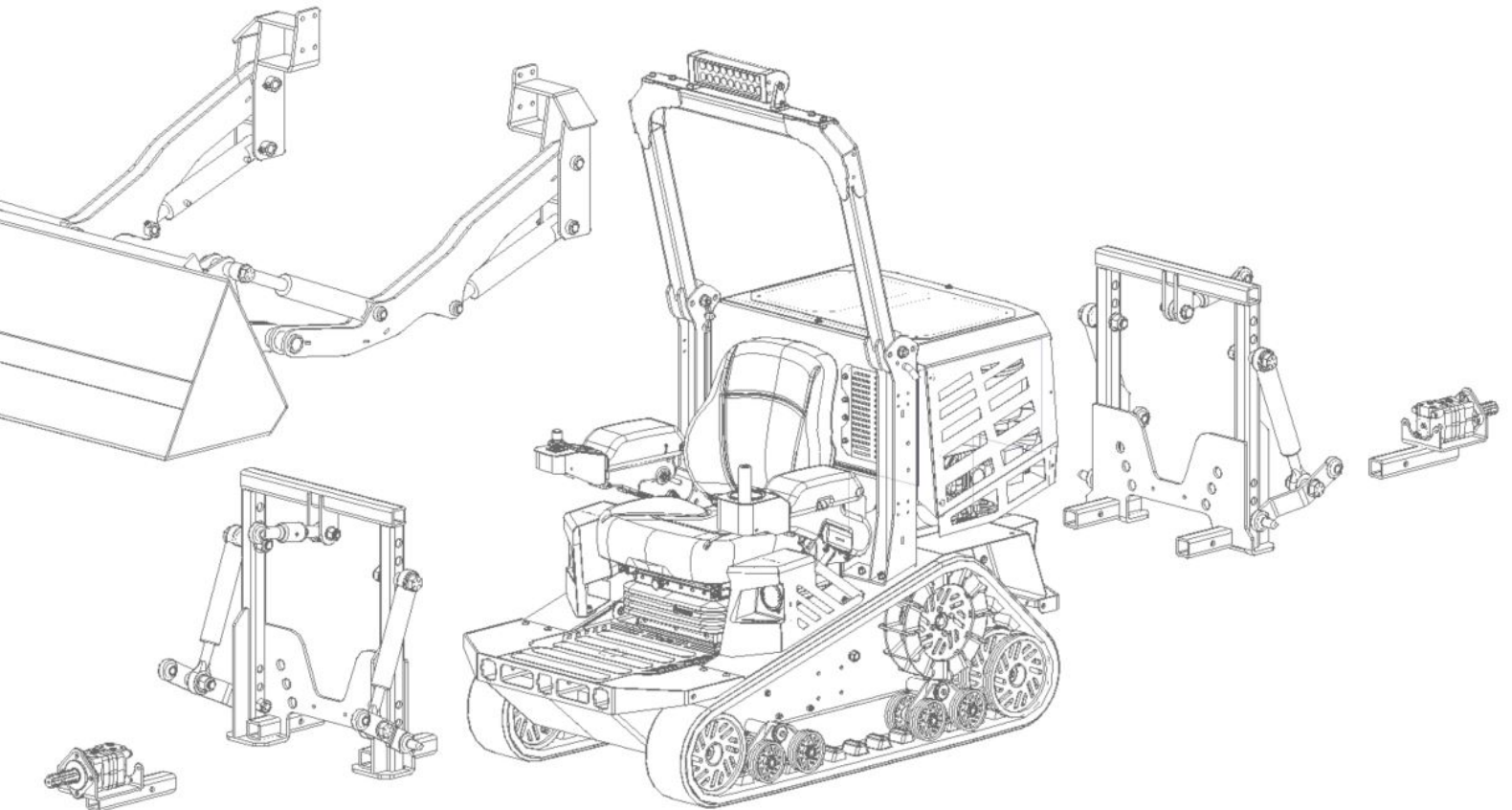

PTO CAT1 3PT

CAT1 3PT PTO

